

1:12 Electric 4WD Climbing car

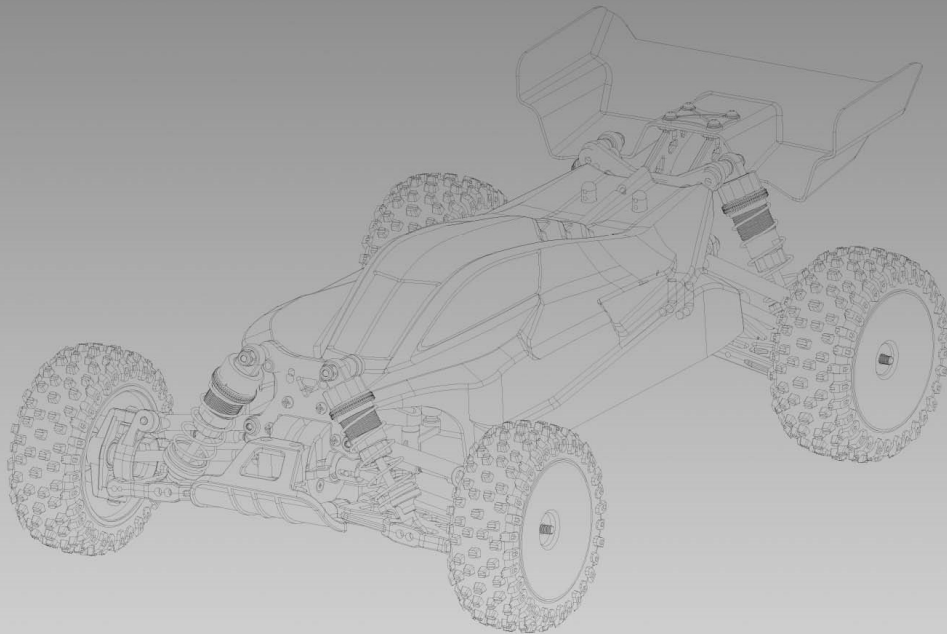

Caution: This model is not a toy, it is designed for users over 14 years of age.

Please use this instruction and the R/C system instruction at the same time.

The instruction is suitable for a type of model whose number is 124008

Safety and caution	1
Troubleshooting • Product introduction	2-3
Instruction of common tools and installation the electronic part...	4
Practice and maintenance.....	5
Assemble exploded view	6-14
Fittings view	15-20

Don't use the same frequency with others at the same time. Or the car will lose control or even lead to serious accidents.

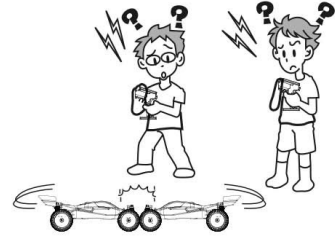

Troubleshooting

Description	Cause	Solution
The car does not operate at all.	Transmitter or receiver is off.	Turn on both transmitter and receiver.
	Batteries are not placed properly in the transmitter.	Place batteries in the transmitter properly.
	The drive battery is not charged enough.	Charge the drive battery.
The car does not follow your operation and control distance not enough long.	Someone else is using the same radio frequency as you are using.	Charge your radio frequency to the one no one else is using, wait until the driver using the same radio frequency finishes driving, or drive your car at a different place.
	There is not enough power in the transmitter or receiver batteries.	Replace the transmitter batteries with new ones and charge the drive battery.
	Not tighten antenna on the transmitter/not fully extend antenna.	Make sure insert antenna into the transmitter and fully extend antenna.



CAUTION

- * Please observe the operation manual or packing explanation to install and use, and some parts should be installed by adults.
- * The product contains small parts, it may cause swallow or choke.
- * Never run an R/C model in the seep or rain, moisture areas, or it may cause the parts malfunction.
- * Please throw the wrapper in time to avoid danger for the children.
- * Regularly examine for damage to the charge, wire, plug, bodyshell or other parts. In the event of any damage, it must not be used until the damage has been repaired.
- * The charge, battery box and battery must insert with the appointed power source of product symbol same.
- * This product must only be used with the original collocation charger.
- * The product is contains the functional outshoots are may be dangerous to the children.

Proportional R/C Using Instruction

① Turn left the steering wheel, the car will turn left. Turning left angle can be adjusted by the degree of wheel twisting.

② Turn right the steering wheel, the car will turn right. Turning right angle can be adjusted by the degree of wheel twisting.

③ Pull the throttle trigger backward, the car will forward. Adjusting the angle of throttle trigger can adjust forward speed of the car. During the car forward, quickly push the trigger forward to stop it.

④ Loosen the trigger to make it return the neutral position when brake. Push the throttle trigger forward, the car will backward. Adjusting forward angle of throttle trigger adjust backward speed of the car.

Introduce the common tools and assemble the electron parts

Tools needed for assembly

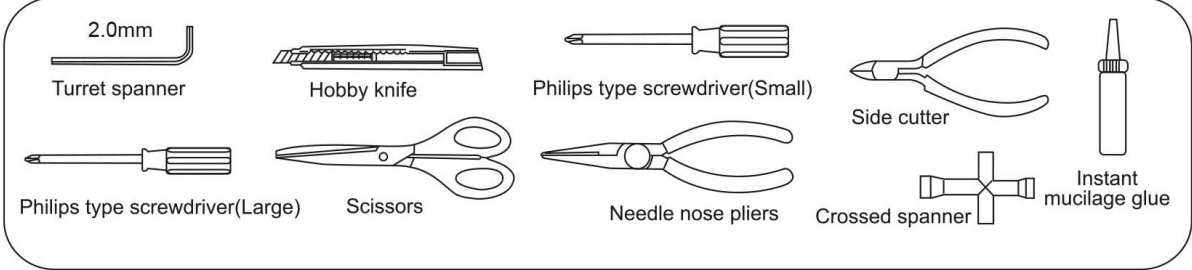

PRACTICE AND MAINTENANCE

Operating program

1. Turn on the power switch **1** on the remote and make sure the power indicator **2** flashes red, then turn on the model car's power switch.
2. The model car on the shelf, gently hook remote control on the trigger **3** to observe whether the car can move forward and backward.
3. Turn the remote control steering wheel **4** to the left or right and make sure that the front wheel's steering follows the command.
4. The model car on the ground, and standing behind the model car, gently hook the remote control throttle trigger **3**, if the model car does not go straight, rotate the remote control front wheel trim **5**, the model car to the right side, the front wheel Turn the trim to the left, the model car leans to the left, and the front wheel trims to the right to rotate until the model car can go straight.
5. Throttle speed adjustment **6** can adjust the model car speed, rotate to the right, hook the trigger model car speed becomes faster, turn left, hook the trigger model car speed becomes slower.
6. OK, ready to run.

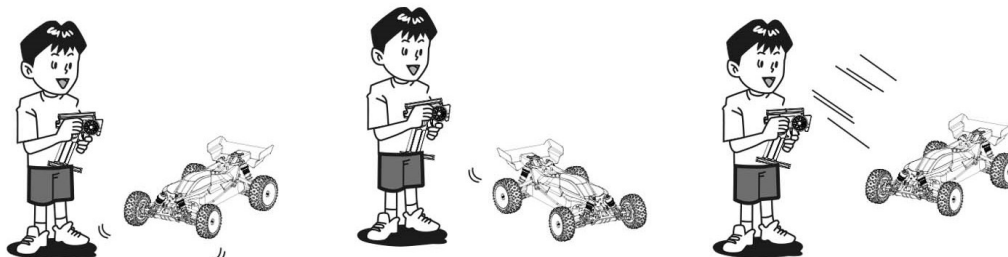
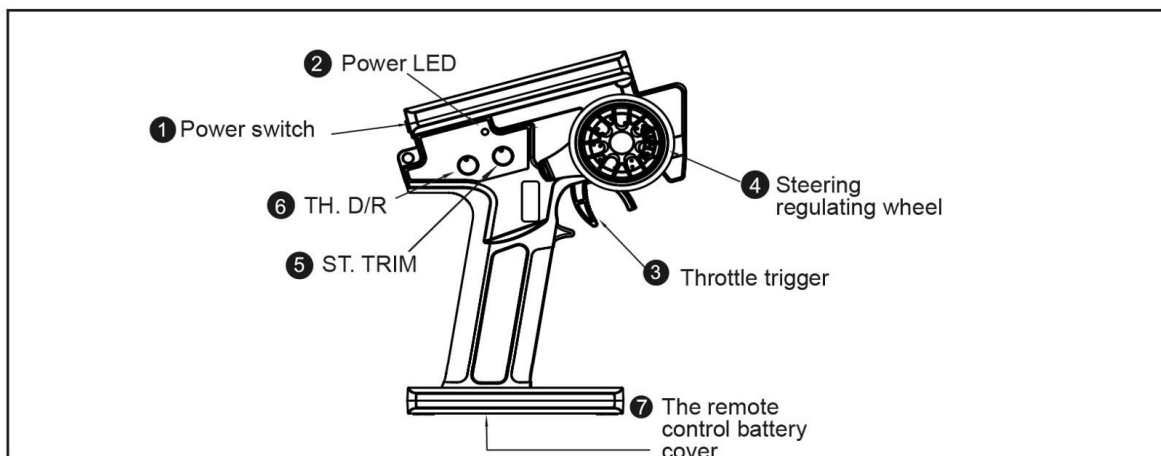

Practice

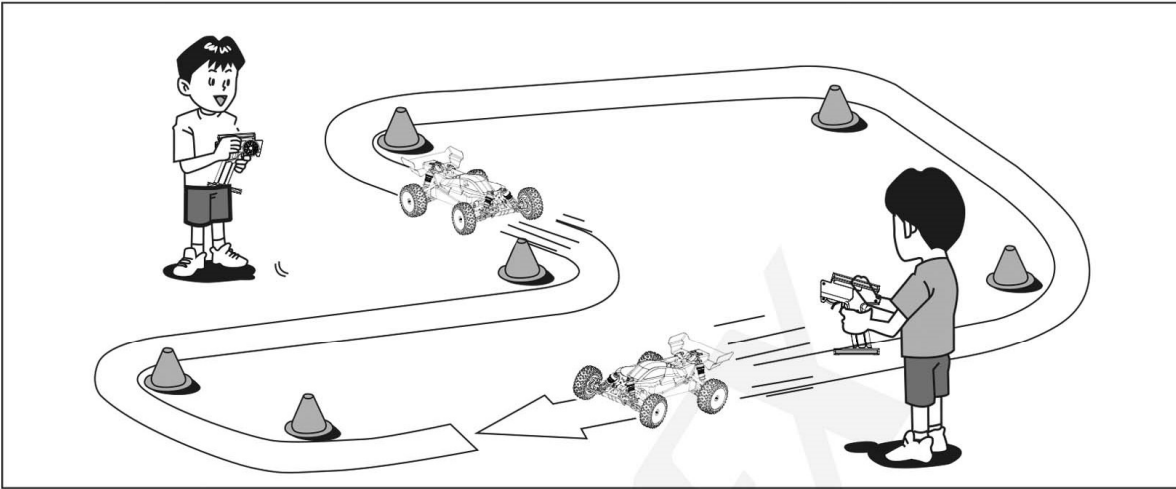

Let's practice! Make R/C car circuit at a wide and safe location using corner pylons (separately available), empty cans or such. Running fast at straight section and slow down at curved section is a basic speed control technique useful when driving R/C car.

Maintain

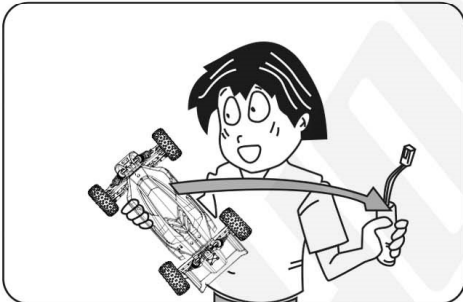

When the car is not in use, you should remove the battery from the car.

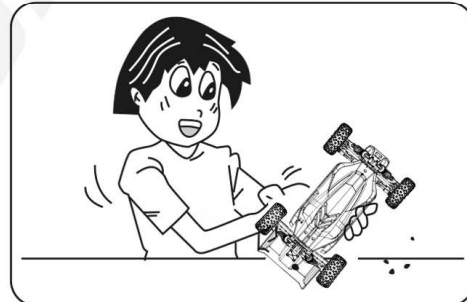

Completely remove sand, mud, dirt etc.

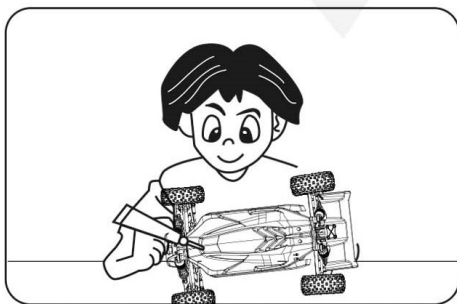

Metal outside should apply the rust prevention oil.

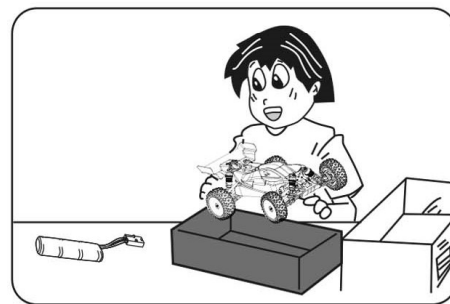

Store the car and batteries separately when not in use.

Assembly Exploded Diagram

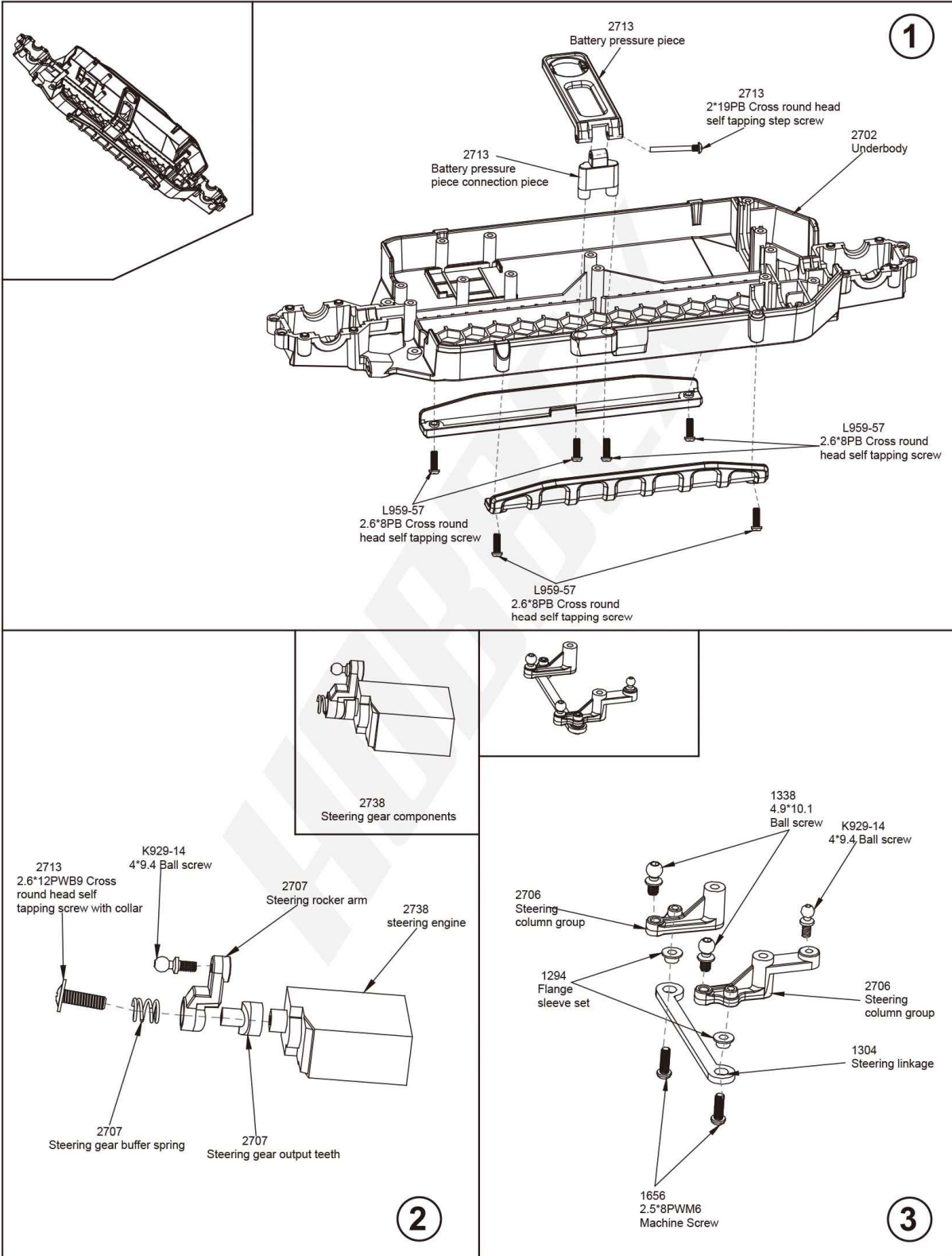

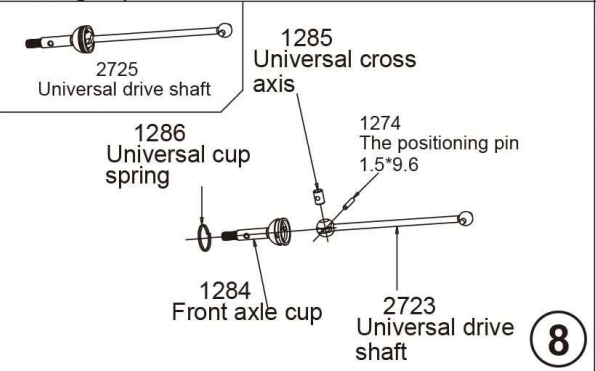
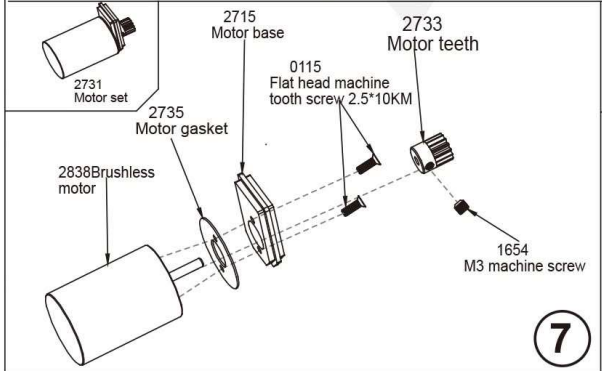
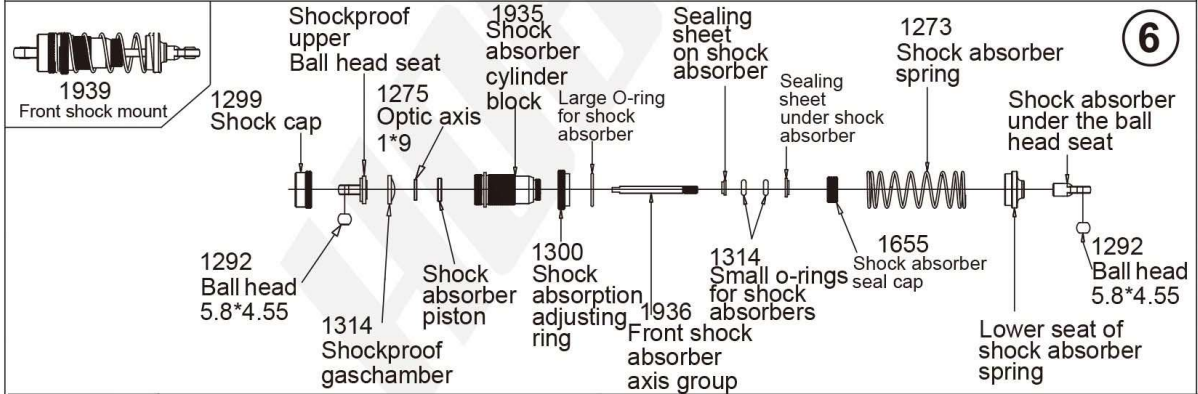
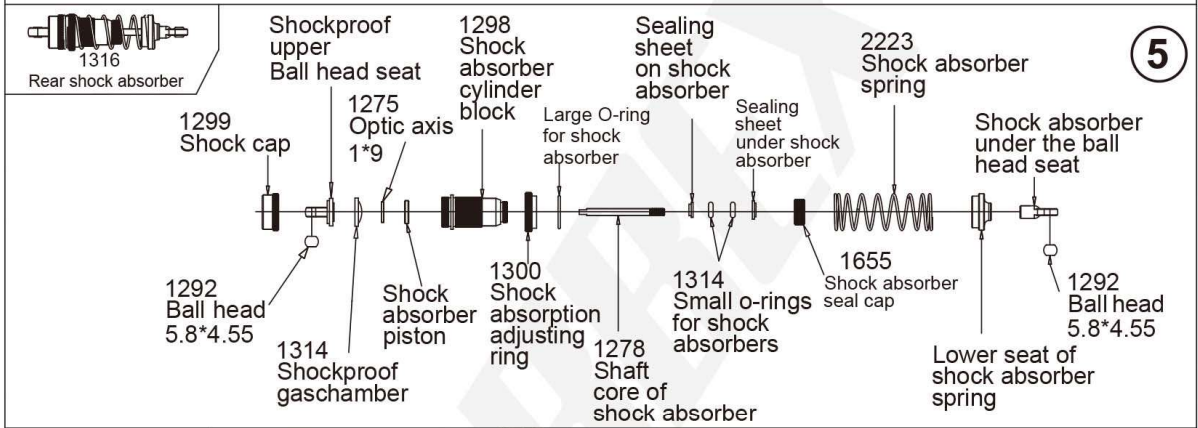
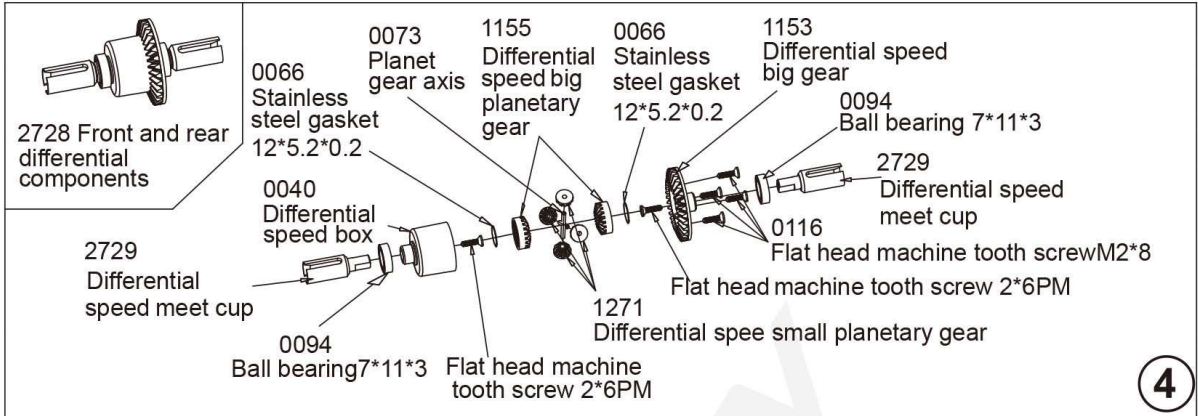

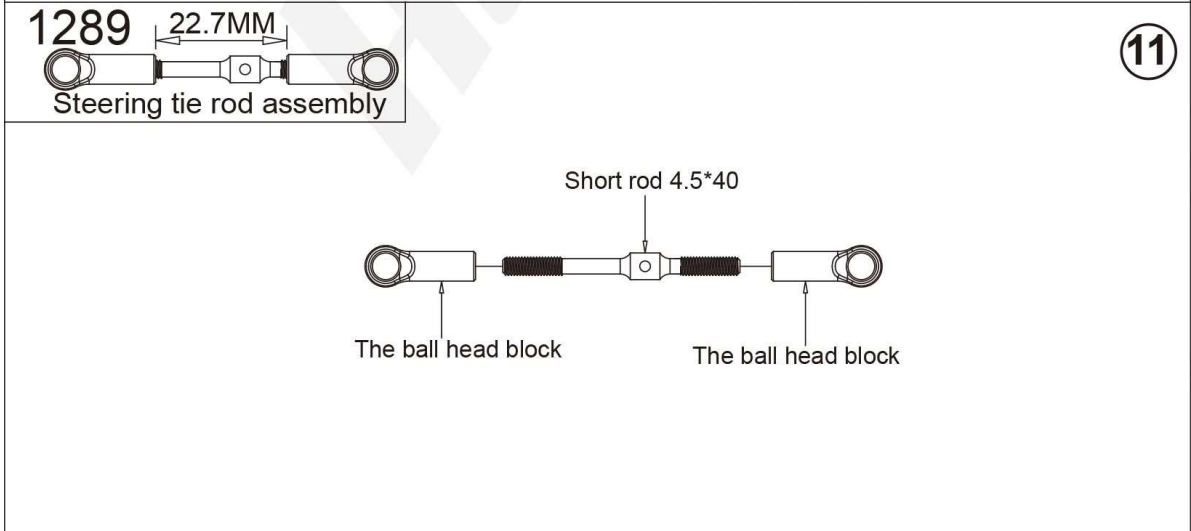
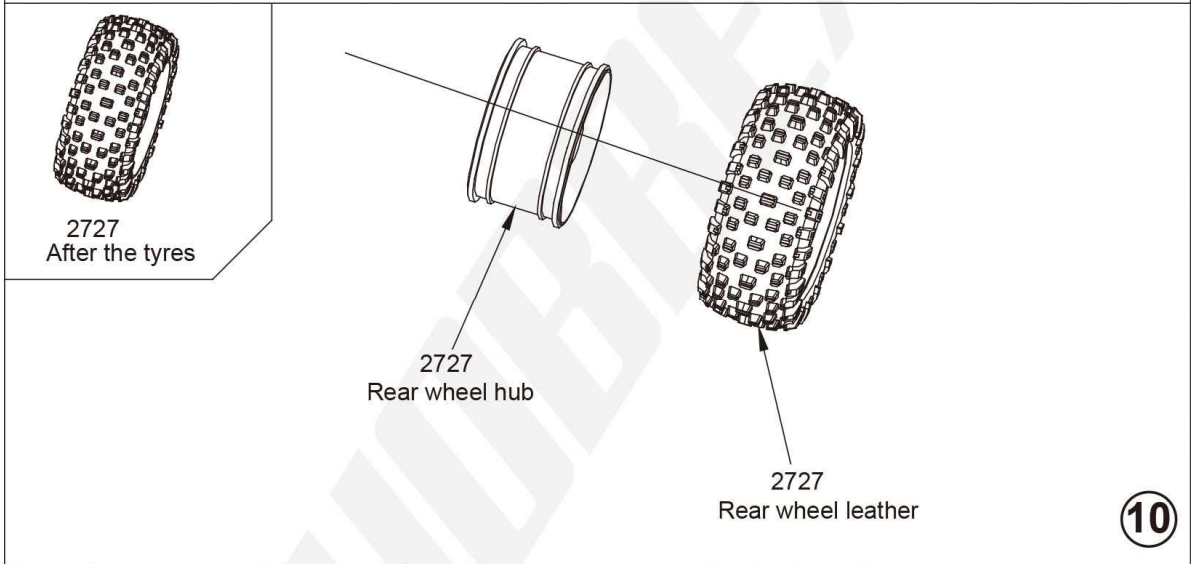
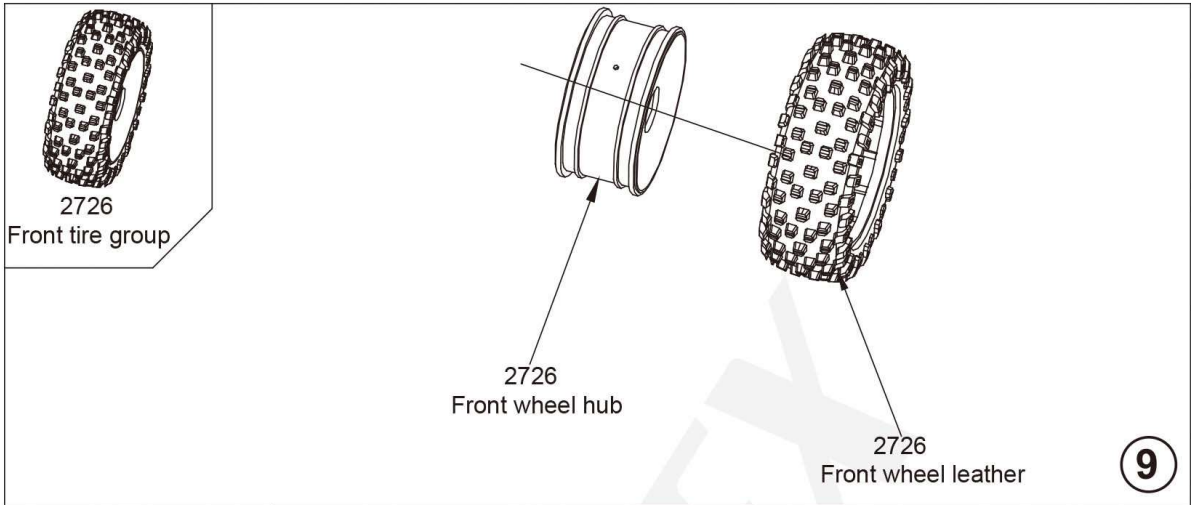

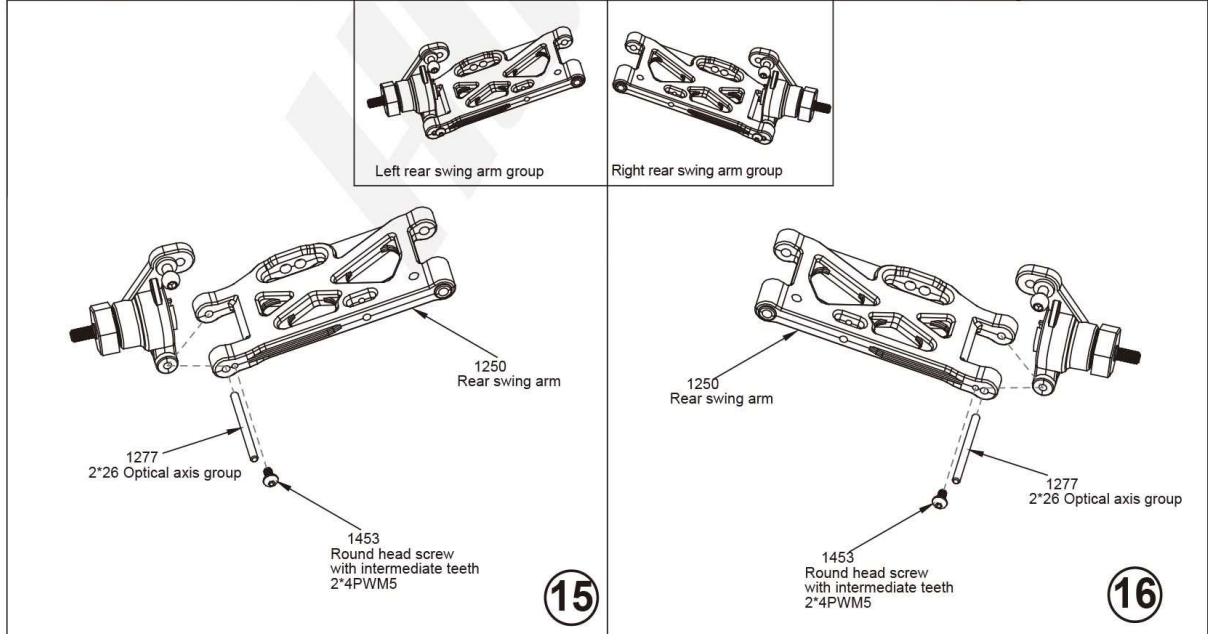
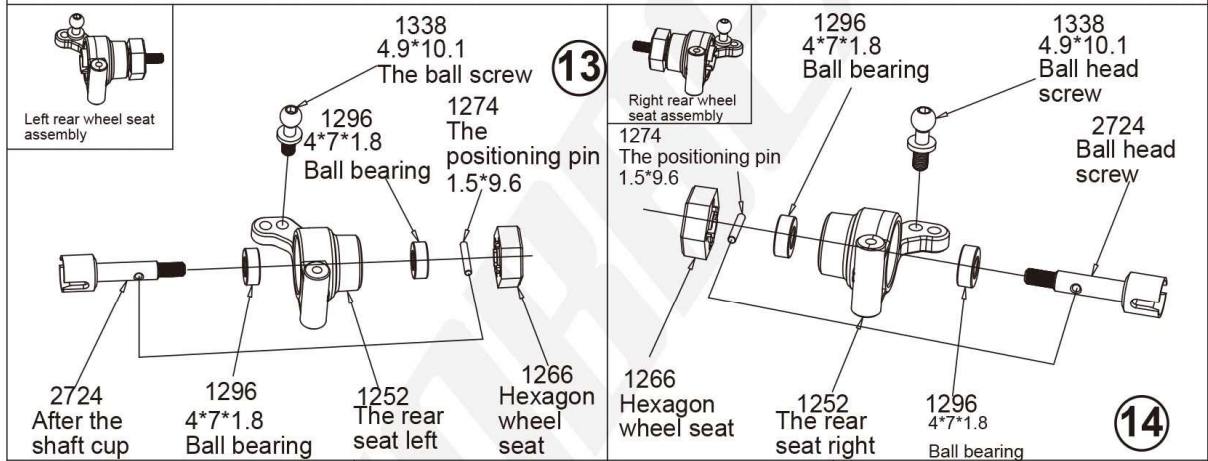
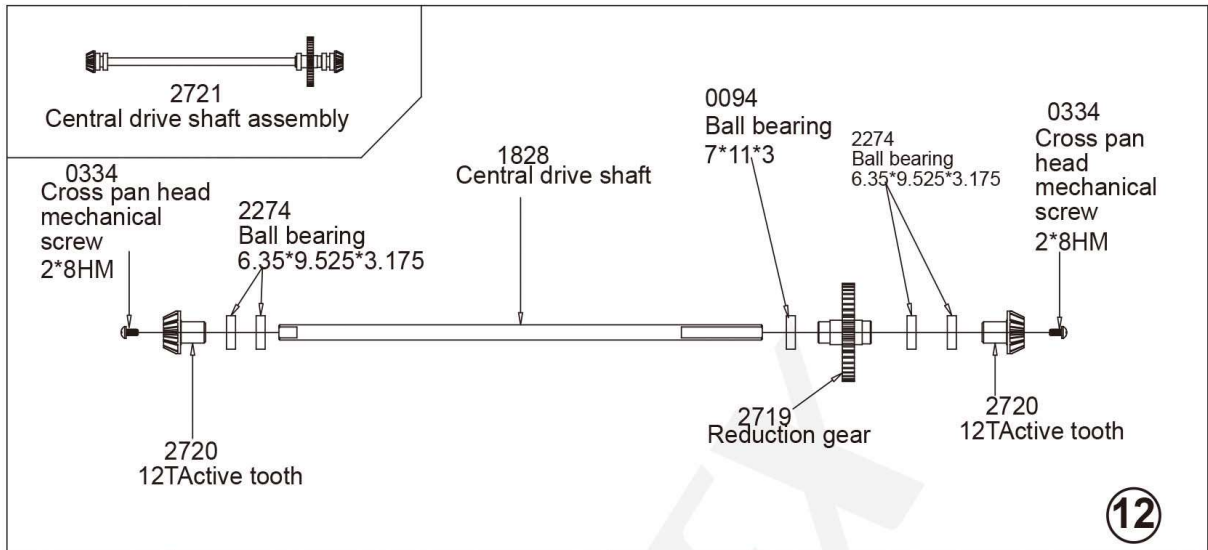

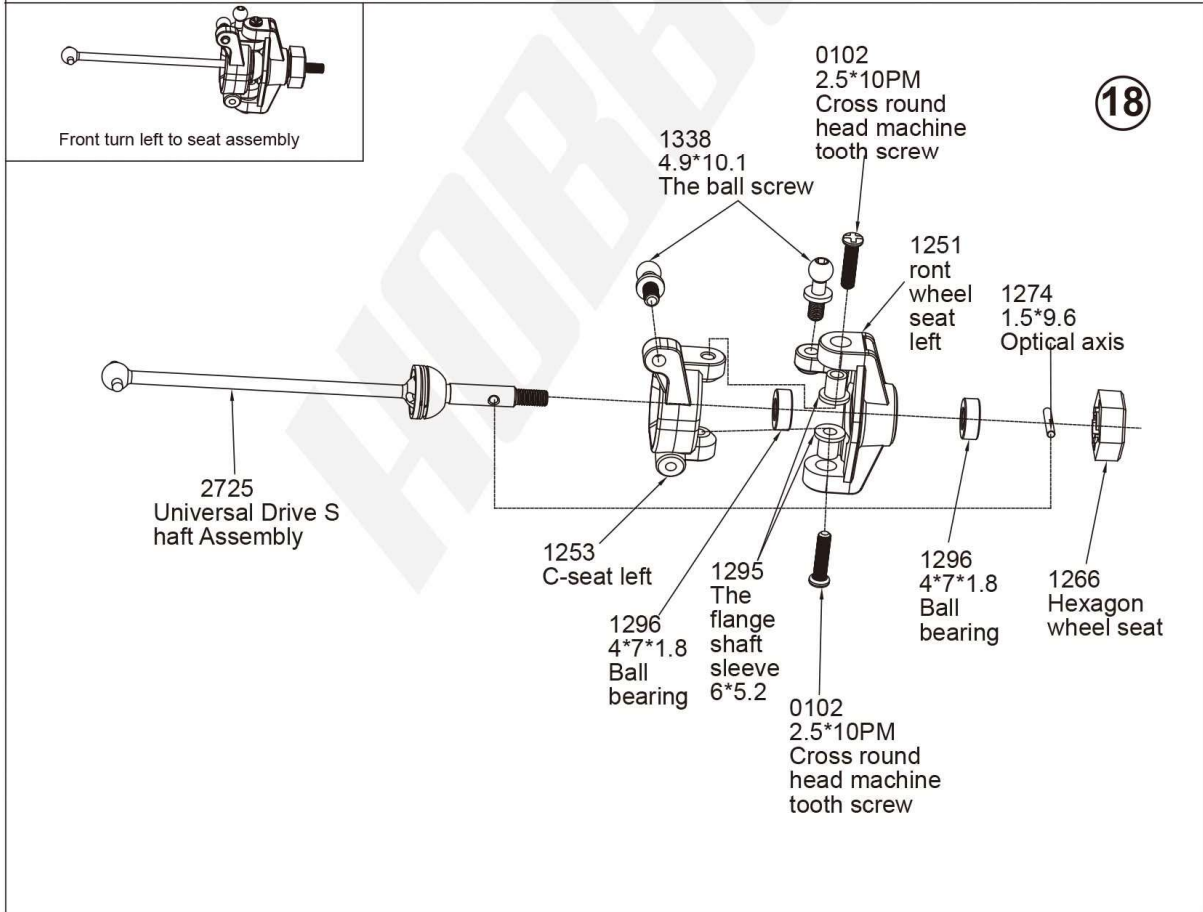
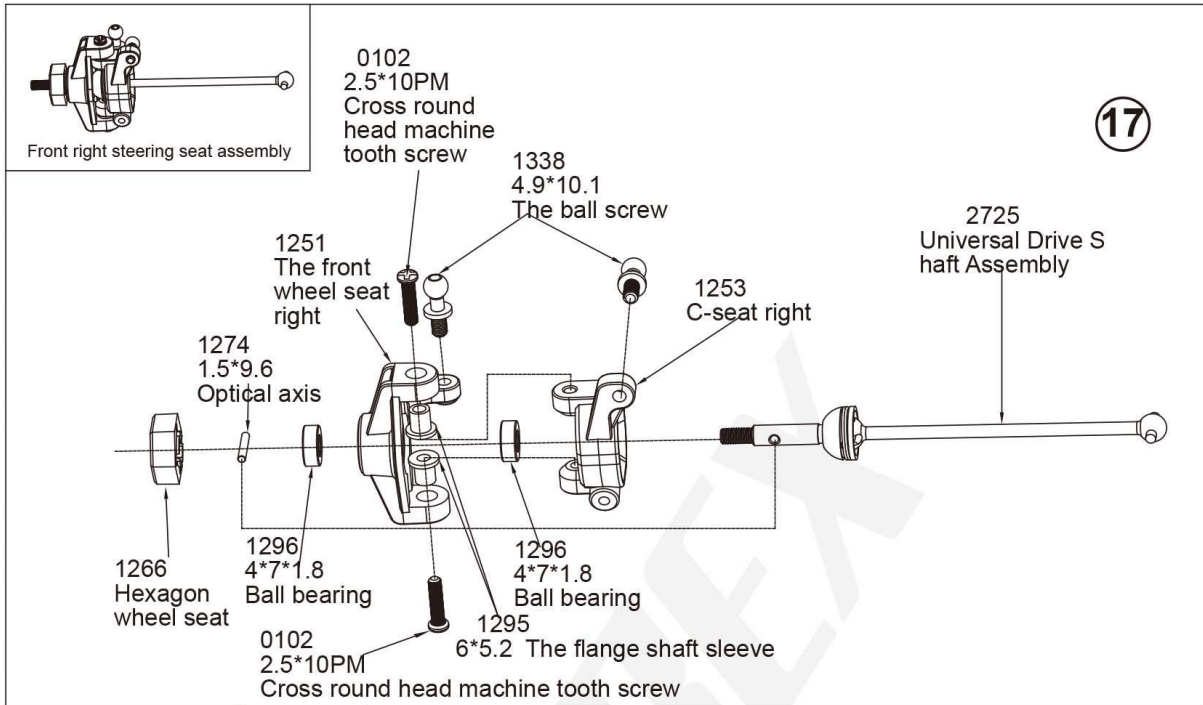

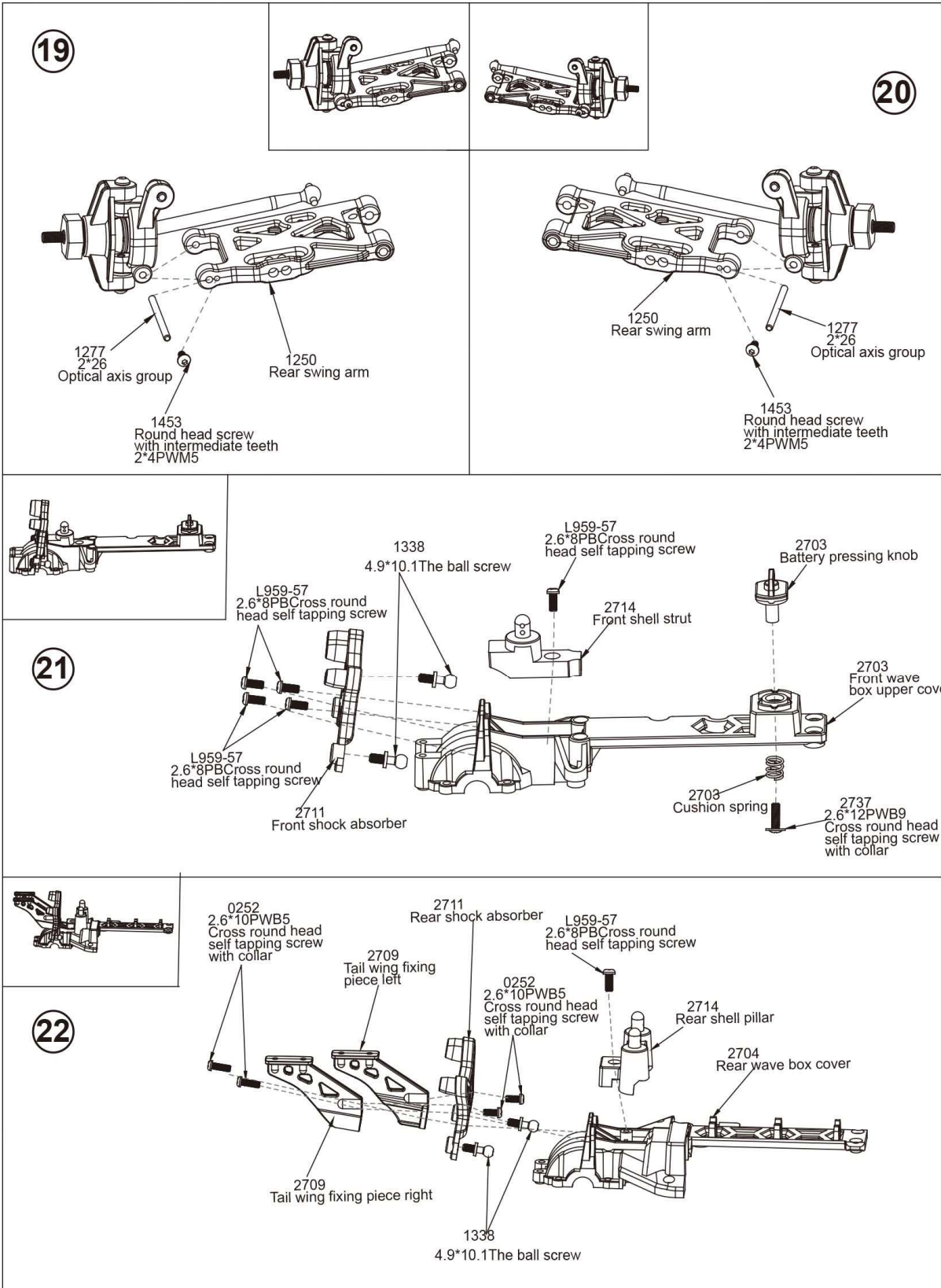

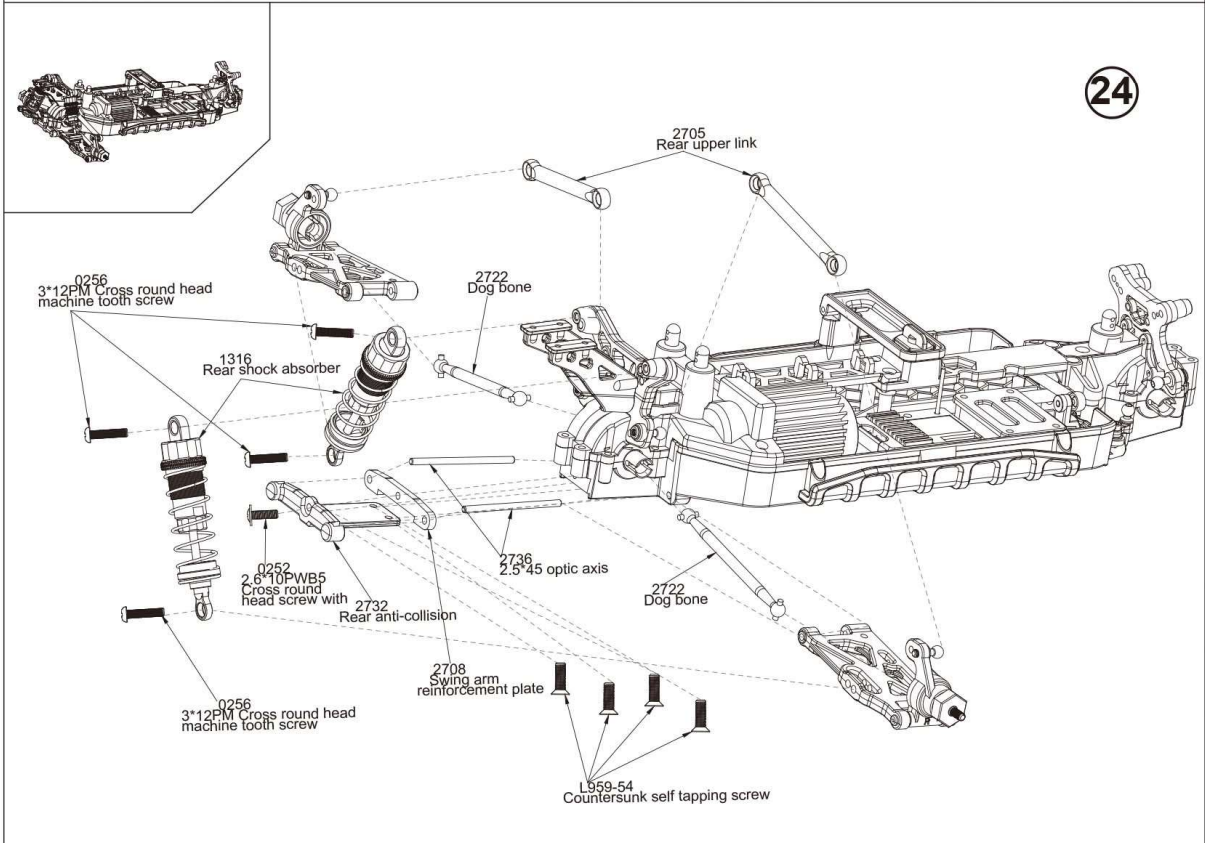
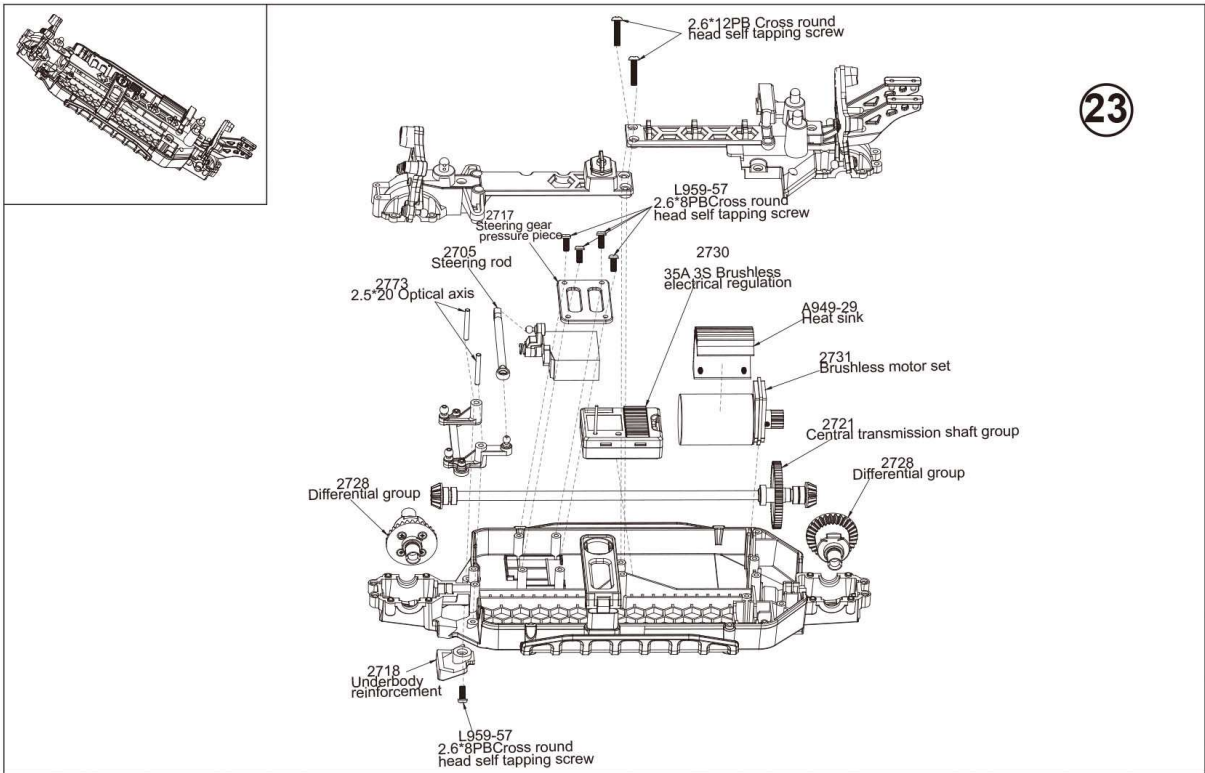

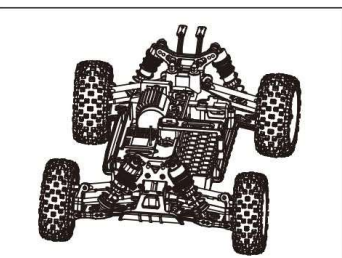
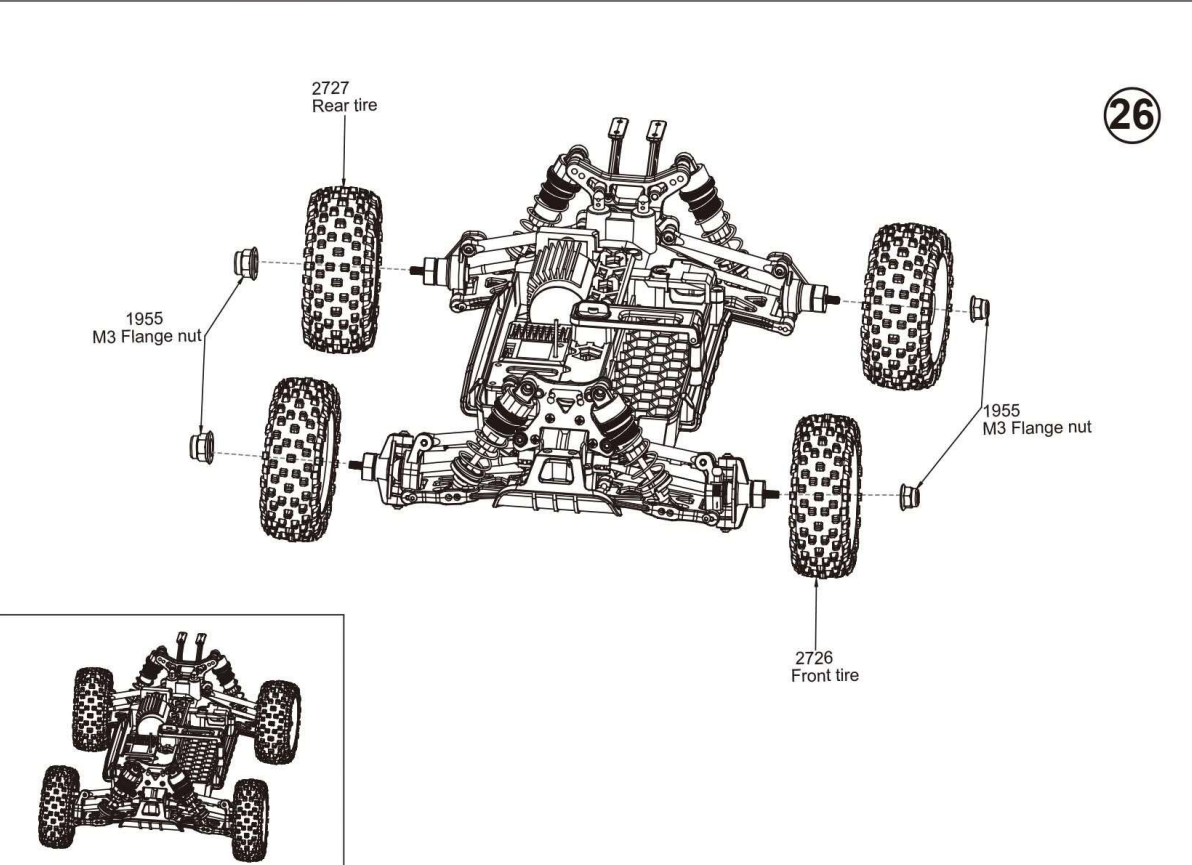
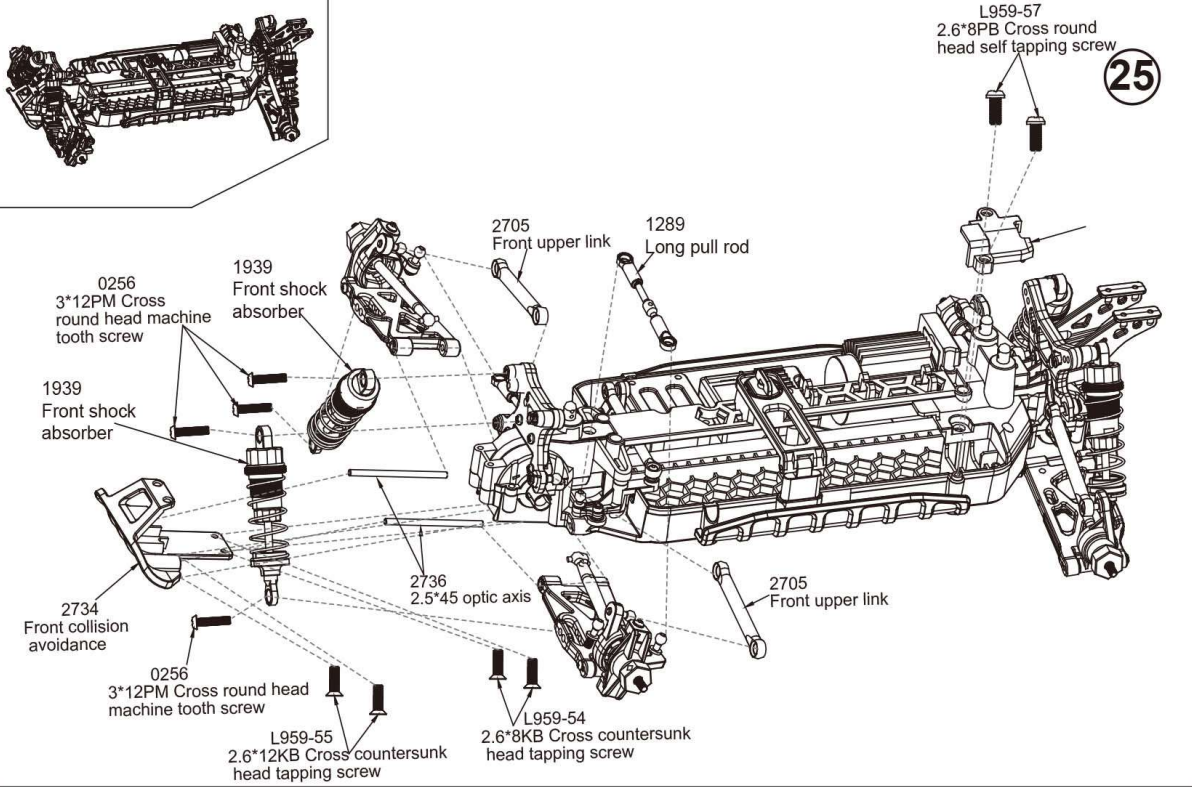
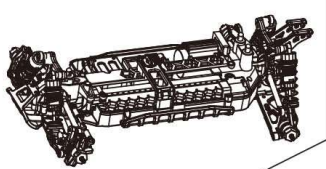

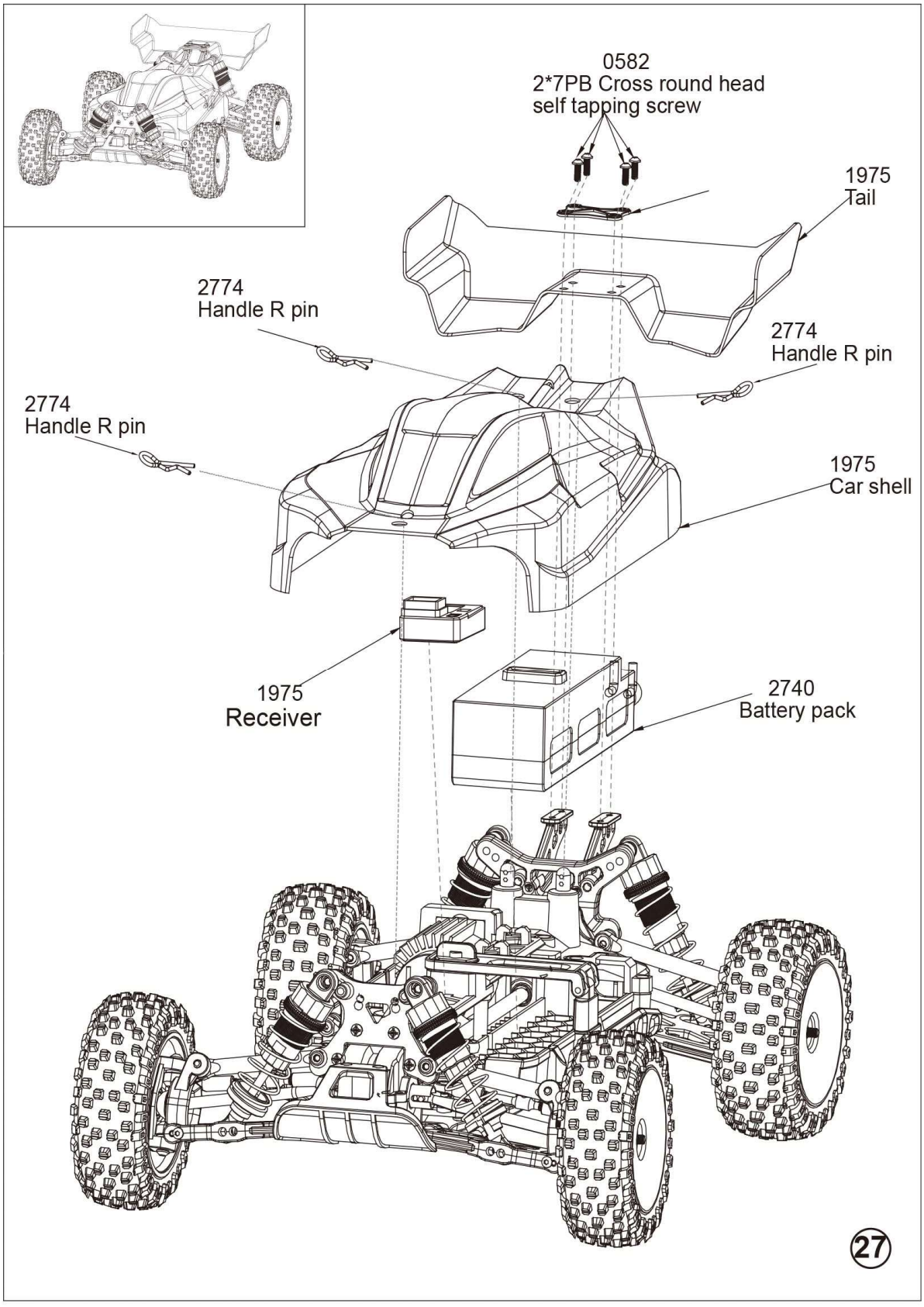

Sale parts view

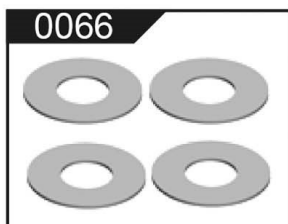

0066

12 * 5.2 * 0.2 gasket set assembly

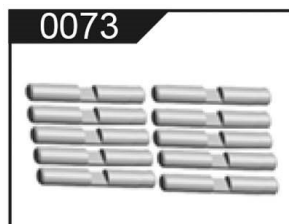

0073

Differential shaft assembly

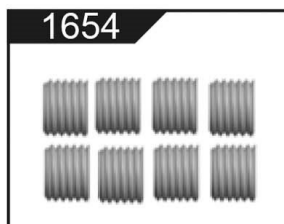

1654

M3*3 Inner hexagonal screw assembly

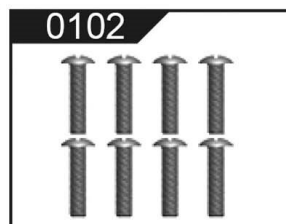

0102

2.5*10PM screw assembly



0115

Flat head machine tooth screw 2.5*10KM



L959-55

2.6*12KB Cross countersunk head tapping screw



0048

USB charging line



0256

3*12PM Cross round head machine tooth screw



2493

V8-104018 Remote control unit



A202-15

2*8KB Cross countersunk head tapping screw



0252

2.6*10PWB5 Cross round head screw with



0582

2*7PB screw assembly



1153

30T Differential Large Teeth(Hardware) Component



2720

12T Active Teeth(Hardware) Group



1155

24T Differential Large Planetary Teeth(Hardware) Group

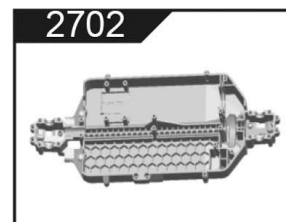

2702

car body assembly



1250

Front and rear arms



1251

Front seat assembly



1252

Rear seat assembly



1253

Type C Block Component

Sale parts view

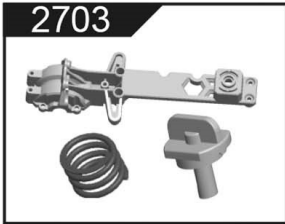

2703 Front wave box cover



2712 Left and right edge protection

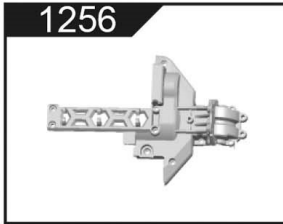

1256 Rear wave box cover



2705 Tie rod group



2706 Steering column group



2707 Steering gear buffer group

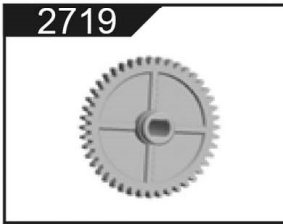

2719 Reduction gear (hardware) group



2708 Swing arm reinforcement plate



2709 Tail wing fixing component group



2710 Rear shock absorber assembly



2711 Front shock absorber assembly

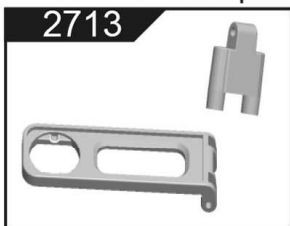

2713 Battery pressure piece set

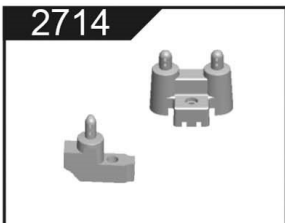

2714 Front and rear shell pillar groups



2715 Motor base group

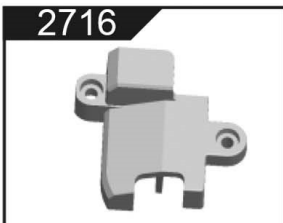

2716 Crimping cover group

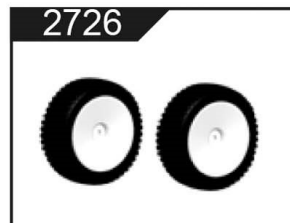

2726 Front tire assembly

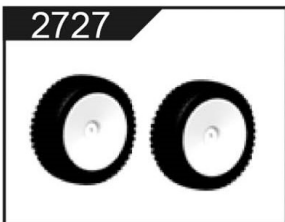

2727 Back tire assembly



1271 10T Differential Asteroid Teeth(Hardware) Group

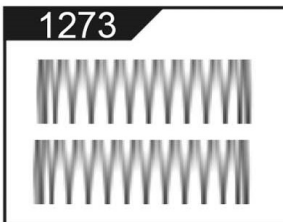

1273 Shock absorber spring assembly

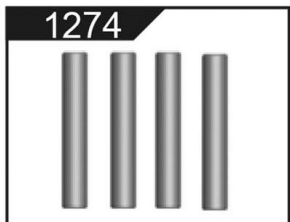

1274 1.5*9.6 optic axis

Sale parts view

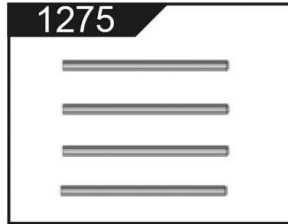

1*9 Optical axis



2.5*8PM Cross head machine screw

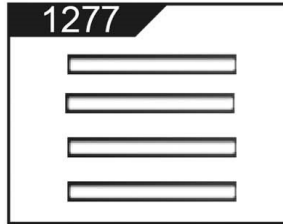

2*26 Optical axis

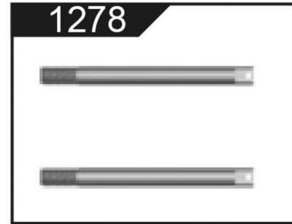

Shock absorber shaft component

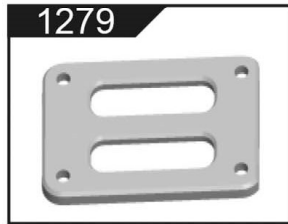

Steering gear pressure component group



Dog bone assembly



Universal drive shaft assembly

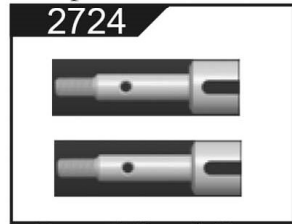

Rear Wheel Cup Component

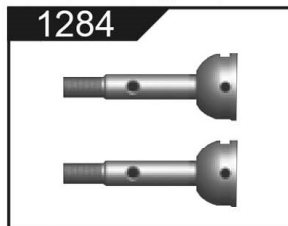

Front Wheel Cup Component

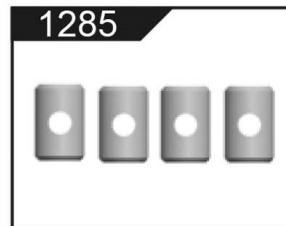

Cross shaft assembly



Universal cup spring assembly



Underbody reinforcement group

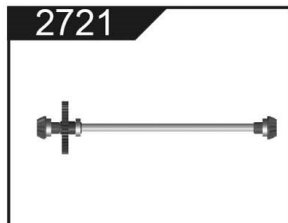

Central transmission shaft group



Long pull bar assembly



Universal transmission shaft group



Differential cup receiving group

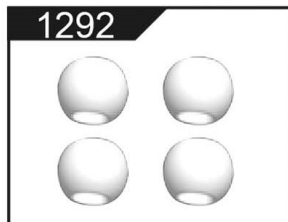

Ball Head Component



Brushless motor set



6 * 2.7 flange sleeve assembly



6 * 5.2 flange sleeve assembly

Sale parts view

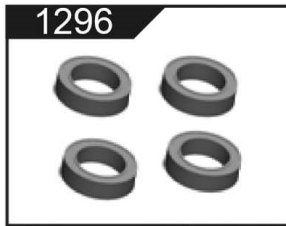

1296
4*7*1.8
Ball bearing assembly

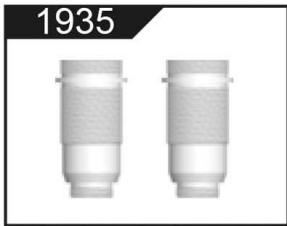

1935
Front shock absorber cylinder block

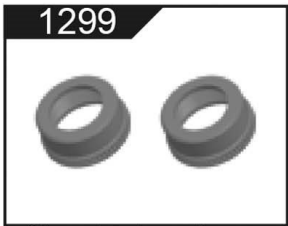

1299
Shock absorber cap assembly

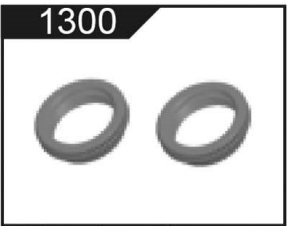

1300
Regulate Ring Component

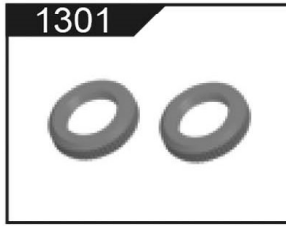

1301
Spring seat assembly

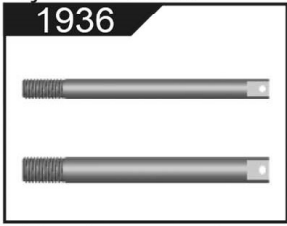

1936
Front suspension shaft core

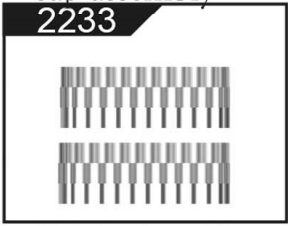

2233
Shock-absorbing spring set



2732
Rear anti-collision group

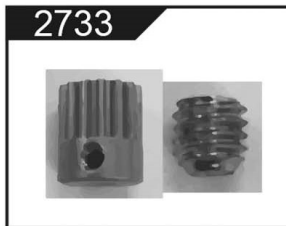

2733
Motor teeth set



2734
Front anti-collision group

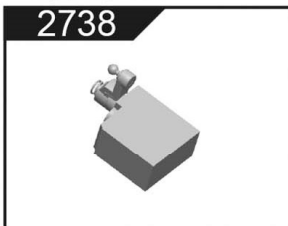

2738
Rudder assembly

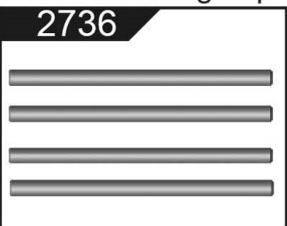

2736
2.5*45 optic axis

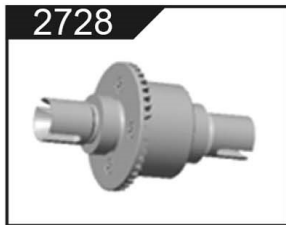

2728
Differential



2730
Brushless electric control group

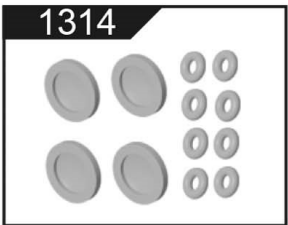

1314
Type 0 assembly

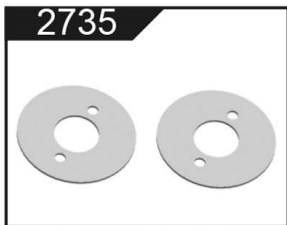

2735
Motor gasket

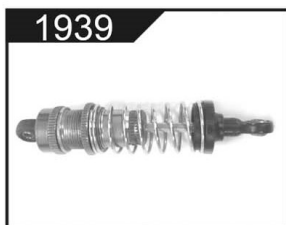

1939
Front shock absorber assembly



1266
Hexagonal wheel seat assembly

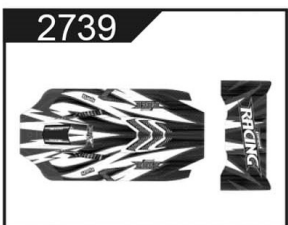









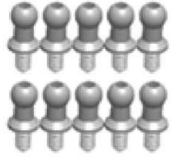
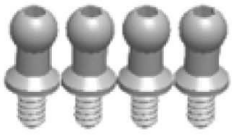

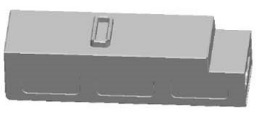
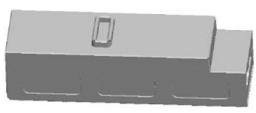
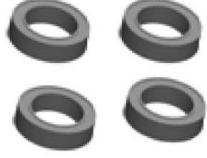

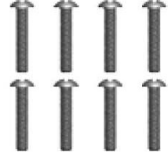
2739
Car shell components

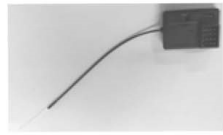

A949-29
Heat Discharge Group

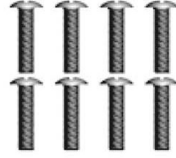
Sale parts view

<p>1337</p> 	<p>1338</p> 	<p>K929-14</p> 	<p>A202-15</p> 
<p>2.5*20 optic axis</p>	<p>4.9*10.6Ball Head screw assembly</p>	<p>4*9.4/4*9.35 Ball head screw set</p>	<p>ST2*8KB screw assembly</p>
<p>2737</p> 	<p>2740</p> 	<p>2741</p> 	<p>A949-35</p> 
<p>2.6*12PWB9 Cross round head self tapping screw with collar</p>	<p>Battery pack (1300Mah)</p>	<p>Battery pack (2000Mah)</p>	<p>Ball bearings 7 * 11 * 3 groups</p>
<p>1304</p> 	<p>2274</p> 	<p>0334</p> 	<p>1989</p> 
<p>Steering linkage</p>	<p>6.35*9.525*3.175 bearing</p>	<p>M2*8Cup head hexagonal screw</p>	<p>Zinc alloy cross sleeve assembly</p>
<p>2022</p> 	<p>L959-54</p> 	<p>L959-57</p> 	<p>1975</p> 
<p>Shock proof sealing cap 11 * 4.5 sets</p>	<p>ST2.6*8KB screw assembly</p>	<p>ST2.6*8PB screw assembly</p>	<p>Brushless receiver</p>
<p>1955</p> 	<p>1316</p> 	<p>1453</p> 	<p>1656</p> 
<p>M3 flange nut</p>	<p>Rear shock absorber assembly</p>	<p>2*4PWM5 Cross round head machine screw</p>	<p>2.5*8PWM6 Cross round head machine screw</p>

Sale parts view

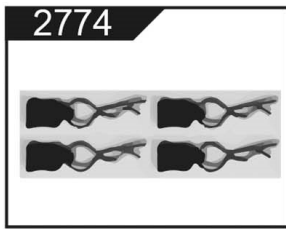

Handle R pin